

PRIME RETAIL SPACE FOR LEASE IN THE HEART OF OCEAN HILL SECTION OF BROOKLYN

1510 Broadway, Brooklyn, NY 11221

FOR LEASE



Retail Space Available

Ground Floor: 6,560 SF

Property Description

Brand new building mixed-use residential building contains 108 apartments and provides affordable housing units for the neighborhood. Building also contains a total of 9,070 SF of ground floor commercial space, some of which is already occupied by Chipotle Mexican Grill. All retail space fronts Broadway, a street that is characterized by retail stores and is heavily trafficked.

Property Information

Address: 1510 Broadway, Brooklyn, NY 11221
AKA: 1510-1526 Broadway
Neighborhood: Ocean Hill

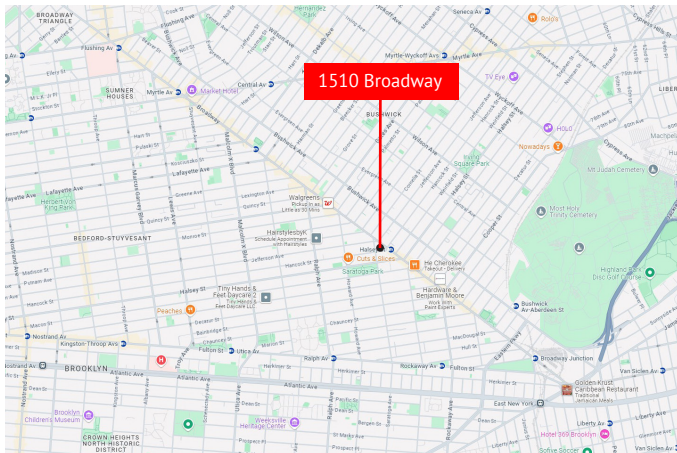

Transportation

Bordered by Broadway and the elevated J/Z subway line to the North, Jefferson and Saratoga Avenues to the West, and Hancock Street to the East. Well serviced by transit with Halsey Street Subway Station adjacent to the building. Q24 and B7 buses stop in front of the building and Citi Bikes is available across the Street.

RENT UPON REQUEST

KATHY ZAMECHANSKY
President & Broker
kzama@aol.com
347.386.9452

KZA REALTY GROUP INC.
P 718-829-5775
F 718-829-6615
www.kzarealty.com

1200 Waters Place
Suite M114
Bronx, NY 10461



PRIME RETAIL SPACE FOR LEASE IN THE HEART OF OCEAN HILL SECTION OF BROOKLYN

1510 Broadway, Brooklyn, NY 11221

FOR LEASE

FLOOR PLAN

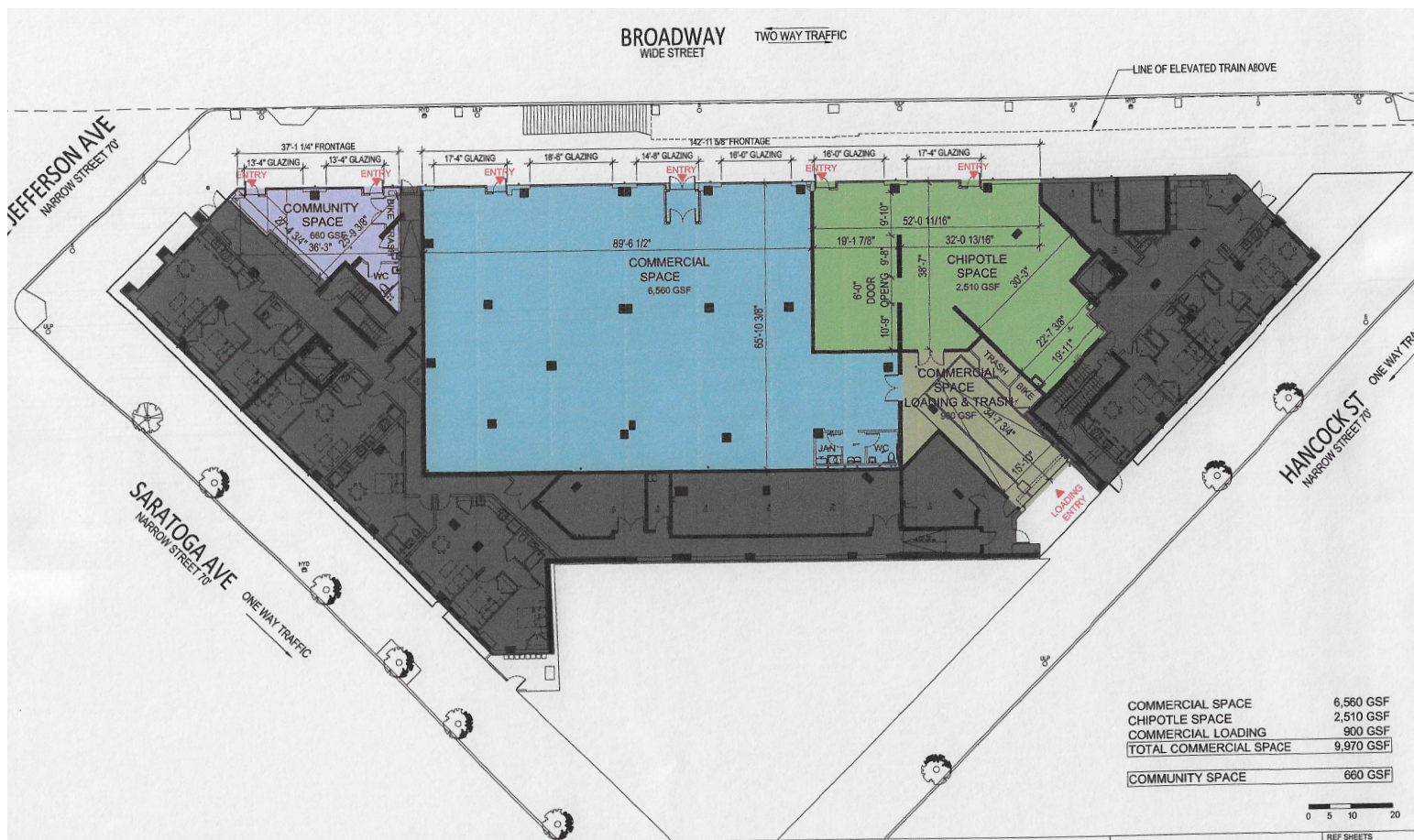

RENT UPON REQUEST

KATHY ZAMECHANSKY
President & Broker
kzama@aol.com
347.386.9452

KZA REALTY GROUP INC.
P 718-829-5775
F 718-829-6615
www.kzarealty.com

1200 Waters Place
Suite M114
Bronx, NY 10461

